



# Penfold Park Master Plan 2021

**City of Burnside**  
**Address:** 401 Greenhill Road, Tasmore SA 5065  
**Phone:** 8366 4200 | **Email:** [burnside@burnside.sa.gov.au](mailto:burnside@burnside.sa.gov.au)  
**Website:** [www.burnside.sa.gov.au](http://www.burnside.sa.gov.au)

## Version History

Draft V.1 for review	16/12/2020
Draft V.2 with staff feedback incorporated	8/1/2021
Draft V.3 based on Council feedback	25/2/2021
Final V.4 based on community consultation feedback	6/4/2021



# Contents

<b>Introduction</b>	<b>4</b>
<b>History</b>	<b>5</b>
<b>The Park in 2021</b>	<b>6</b>
Key Site Features	6
<b>Strategic Alignment and Trends</b>	<b>10</b>
Strategic Alignment	10
Demographics	12
Community Engagement	13
<b>Principles</b>	<b>14</b>
<b>Master Plan</b>	<b>16</b>
Future Works Map	16
Future Works Funding Table	18





# Introduction

Situated at the top end of The Parade, Magill, Penfold Park is a refuge from the surrounding built-up suburbs, with Park users enjoying the large open space, trees and relaxed atmosphere. Courts, playgrounds and a rotunda with a barbecue add to the appeal, while vegetation helps to shield much of the Park from surrounding streets.

Despite the high level of community interest in the Park, it is relatively underutilised when compared to some of the City's other large parks of similar size, including Glenunga Reserve, Bell Yett Reserve, Newland Park and Tusmore Park. This master plan will provide an evidence-based and strategic approach to future works and use, and will ensure that Penfold Park is able to cater to all members of the community now and in the future, as the need for open space increases. Further, the master plan will ensure that future works are not ad hoc, but rather planned and complementary. It will also provide a basis for scheduling works in a financially sustainable way.

The need for a master plan was identified in Council's Open Space Strategy. It has been developed by analysing the following:

- Council's strategies and guides,
- current and future demographics of the area,
- emerging trends and community needs,
- community consultation results, and
- requests from the community relating to the Park in recent years.

# History

Penfold Park is named after Christopher Rawson Penfold, first Chairman of the Burnside District Council in 1856 and founder of the Penfold Winery. The Park, previously known as Penfold Reserve, was redeveloped from a barren space by Council in 1993, after extensive community consultation.

Minimal modifications have occurred since the Park's construction in 1993, apart from a change to the location of the large playground.

In 2019, the toilet block was updated to a semi-automatic version in order to address antisocial behaviour associated with the facility.

In 2019, extensive community consultation explored the idea of developing the City of Burnside's first skate park. Four sites were investigated, including Penfold Park. The site was well-suited to a skate park, and consultation showed that of 754 responses, 397 would use a skate park. Of the four locations, Penfold Park was the second-most popular location, with 291 respondents selecting this as a suitable site, behind Kensington Gardens Reserve. However, due to opposition from a number of residents who live around the site, it was decided not to pursue Penfold Park for a skate park.



*Photographs circa 1993*

# The Park in 2021

At 37,930m<sup>2</sup> Penfold Park is the sixth largest urban park in the City of Burnside. It caters for a range of active and passive recreational opportunities, including walking, tennis, netball and basketball, playgrounds, picnics and relaxing. A toilet and off-street car park provide ease of access to the Park.

## Key Site Features



### Furniture

Older style benches and picnic settings are provided throughout the Park.



### Rotundas

The Park contains two rotundas. The large rotunda is used by walkers as a rest stop, and also for family gatherings and events.



## **Drainage area and stone bridge**

A drainage basin consisting of a soakage pit and silt trap channels water from the eastern side of the Park. A raised stone bridge ensures pedestrians are able to pass through the Park during heavy rain events.



## **Pathways**

Pathways provide connections and access points for pedestrians. The main path through the Park from Romalo Avenue to The Parade is paved, while the remaining paths are compacted rubble or dirt.

# The Park in 2021



## Courts

Two courts are marked for both tennis and netball. The courts are set up for netball during the winter season, and are used by the Mordialta Netball Club. They are set up for tennis during the remainder of the year. A basketball hoop and key adjacent the courts is the Park's newest addition.



## Tree groves and lawn area

A key feature of the Park is the large open lawn area, as well as the extensive tree grove, consisting of ornamental pear trees providing a change of colours throughout the seasons. Well-established native plants including wattles, eucalypts and Cypress pines are planted along the eastern, western and southern edges of the park, providing shade for park users, and a screen from traffic.





## Playgrounds

The Park features a small playground catering to young children, and a large playground with more challenging elements for older children. The large playground is covered by a shade sail.



## Car park

An off-street car park located off The Parade caters to the Park users. Additional on-street parking is available on Romalo Avenue.

# Strategic Alignment and Trends

## Strategic Alignment

The Burnside 2030 Strategic Community Plan articulates Council's vision, goals and priorities over a 10 year period, and is the overarching guiding document for Council. It helps to direct projects and programs, while also responding to emerging opportunities and challenges. Its three goals are all relevant to the Penfold Park master plan:

- A resilient, healthy and connected community.
- Our city will be a leading environmental custodian.
- A city of accessible and liveable precincts, open spaces and treasured heritage.

This master plan has been prepared as a result of a need identified in the Open Space Strategy, and ongoing suggestions from residents for various improvements at the Park. These suggestions appear to be increasing, likely due to the ageing facilities in the Park, which has remained largely untouched since it was developed in 1993.

The Open Space Strategy suggests that a master plan be prepared for the Park to increase function and capitalise on existing facilities, and to establish the Park as a key district recreation park. The City of Burnside uses the public open space hierarchy to determine the catchment area of any park. The public open space hierarchy has four levels (from smallest to largest): Local, Neighbourhood, District and Regional. Penfold Park is classed as a District park. District parks have the capacity to attract people from more than just the nearby suburbs, due to their size, facilities, quality or level of activity.

For this reason, it is important that Penfold Park is designed to meet the needs of a wide range of visitors, who may come for a variety of reasons, including organised or social sport, dog walking, social events and children's play. The need for the Park to cater to a wide range of users is in line with the Community Land Management Plan, which sets out a series of management objectives for the Park. These management objectives state that a range of recreation opportunities for a variety of users should be provided, to facilitate a high level of use.



The Open Space Strategy lists a number of specific suggestions for improvement at Penfold Park, which have been considered in the development of this master plan. Recommendations include:

- Upgrade, modify and provide additional pathways where required to achieve accessible and appealing routes for walking.
- Provide additional seating to playground areas with increased connections (locate seating to higher side of playground for surveillance).
- Develop shade and review location of playgrounds.
- Provide additional landscape treatments to drainage reserve and detention basin.
- Increase connection to adjoining reserves particularly Romalo Reserve.
- Relocate picnic benches adjacent to playground areas and barbecue.
- Increase seating within gazebo to improve function and usability.
- Consider the development of tennis courts as a 3-on-3 basketball court to increase function and youth activity.

In line with the State Government's 'Game On' framework, it is expected that a revised Sport & Recreation Strategy will have a strong focus on unstructured activities. It is important that Penfold Park encourages members of the community to be involved in unstructured physical activities that suit them. A review of the Sport and Recreation Strategy will occur in 2021/22, subject to the 2021/22 budget process.



# Strategic Alignment and Trends

## Demographics

In 2019, it was estimated that the population density for the suburb of Magill was 24.18 persons per hectare, higher than the City of Burnside's average of 16.65 persons per hectare.

In 2016 the dominant household type in the area (Magill, Rosslyn Park, Auldana and Skye) was couple families with dependants, accounting for 34.4 per cent of all households. It is predicted that this trend will continue in 2031 and 2041. For this reason, it is important that Penfold Park contains facilities which can be used by youth and their parents to explore nature and be active, whether this is through unstructured activities on the open grassed areas and playground, or through structured sport on the courts.

While households consisting of families with children is the most populous household type, lone person households are expected to increase by 2031 and again by 2041, when they will make up 27.2 per cent of households in the area. Along with facilities for youth and their families, it is also important to create a space which encourages and provides for intergenerational social opportunities, to ensure that members of the community remain connected.



## Community Engagement

To assist with the development of this master plan, community consultation was conducted to determine the key priorities for local residents and users of Penfold Park. Consultation was mailed to houses in surrounding suburbs, and was also available online for any member of the community to complete. To complement this, an information session was held at the Park in October 2020, where members of the public were able to meet with Council staff to ask questions and provide feedback. A second round of consultation on the draft master plan was completed in March 2021. The results form part of an evidence base which has informed the development of the master plan.

### Most common reasons that residents like Penfold Park



### Community's priorities for the Park

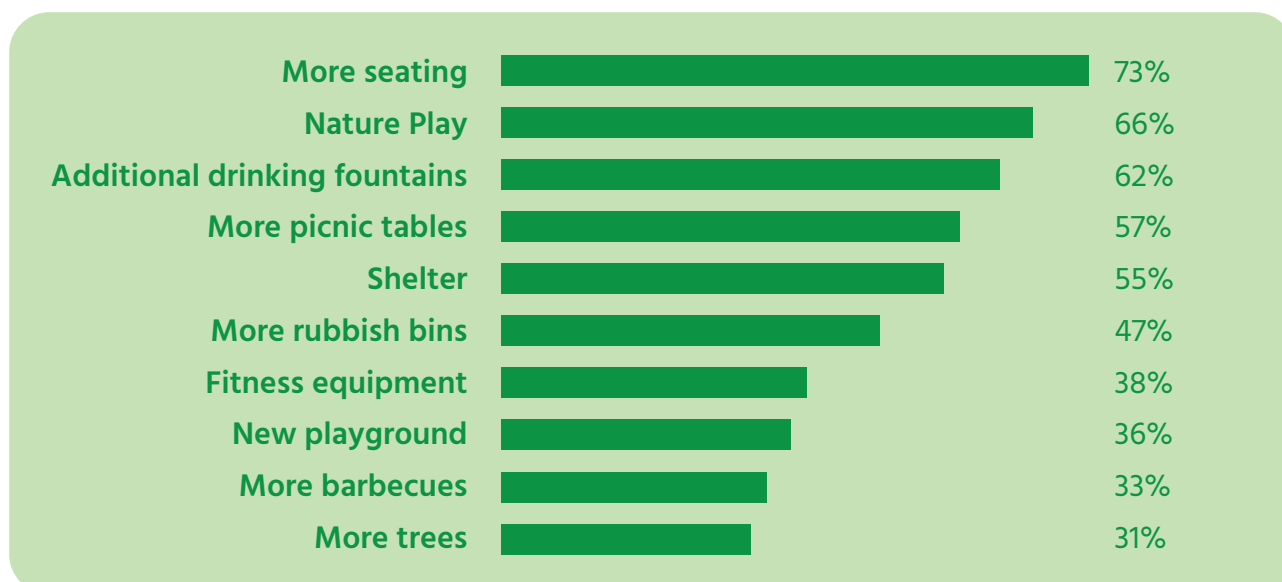

The elements of the Park that the community rated in worst condition were lighting, barbecue areas and seating.

# Principles

## Accessible

- Improve pedestrian access through the Park.
- Ensure Disability Discrimination Act (DDA) compliance, allowing safe and convenient access for all.
- Improve connectivity through a network of pathways, to link key Park features.

## Atmosphere

- Provide a place for all members of the community to enjoy a range of active and passive recreation activities.
- Provide a large open space which people can enjoy and feel safe in.

## Family friendly

- Enhance opportunities for families/friends to gather and socialise.
- Provide park furniture and recreational facilities which allow children and their parents/grandparents/carers to safely play.

## Natural setting

- Maintain and enhance the natural setting, including the open grassed areas, tree plantings, wildlife habitat and linkages, and creek area.
- Provide educational opportunities for Park users to explore and learn about the Park's flora and fauna.
- Use recycled materials where possible in the Park.

## Unstructured exercise

- Offer a range of opportunities for Park users of all ages to engage in unstructured activities that help them be physically active.
- Maintain facilities that promote physical activity to a high standard.



# Master Plan

The following table and map indicate future works for Penfold Park, to be conducted from 2021/22 onwards. Each element has been included based on results of the community consultation, maintenance requirements, adherence to relevant Council strategies, policies and plans, staff input, and legislative requirements.

The priorities have been set in a staggered manner, to ensure that there is sufficient budget to accommodate these over coming years. Items will be replaced or installed in line with Asset Management Plans or when budget is allocated through the annual budget process. Elements which are also listed in Council Asset Management Plans, as well as those which rated particularly highly in the community consultation and community expectations, or which have a higher level of risk in their current state, received a higher priority.



## Future Works Map

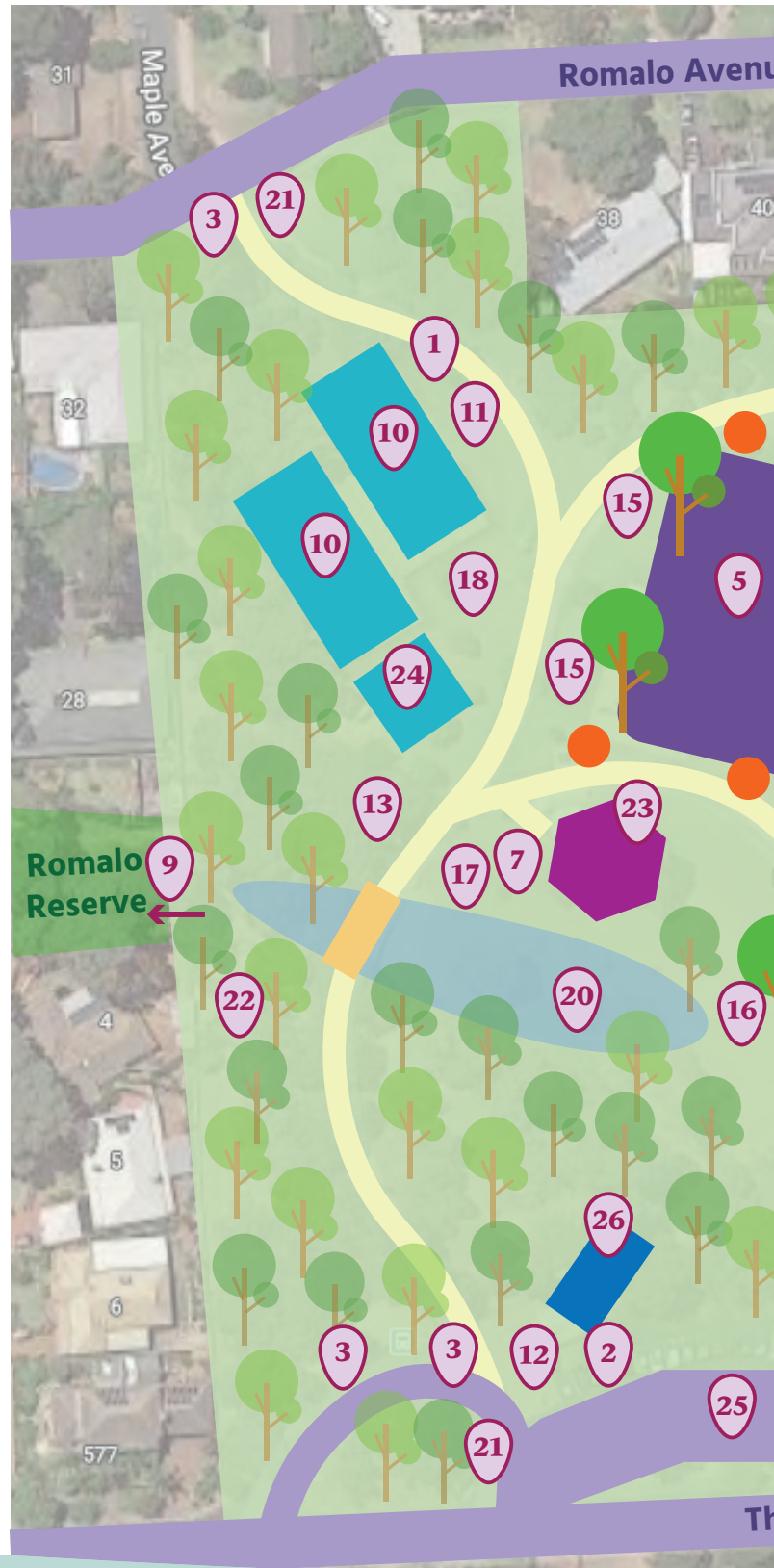





9



10



11  
12



13



14



16



15



17



18



19



20



21



22



23



24



25



26



27



*\*Images are for illustrative purposes only. Actual designs may vary.*

# Master Plan

## Future Works Funding Table

*\*Results of community consultation conducted in October – November 2020.*



Map #	Element	Action	Justification	Priority /Phase
1	Bike rails (east of courts)	Remove 3 rails, install 2 new rails.	Due for replacement according to AMP.	High Phase 1
2	Bike rails (south of toilets)	Remove 1 rail, install 1 new rail.	Due for replacement according to AMP.	High Phase 1
3	Bollards	Install bollards at Romalo Ave and The Parade.	Members of the public are driving cars onto the reserve to unload and reload items (chairs, eskies, etc.), which is prohibited under by-law 3.	High Phase 1
4	Paths (rubble)	Pave rubble paths.	Due for replacement according to AMP.	High Phase 1
5	Playground (large)	Construct new expanded premier playground, incorporating traditional and unique elements, including nature-inspired elements and unstructured recreation opportunities for all ages.	AMP indicates that playground replacement is required in 2021/22.	High Phase 1
NA	Playground (small)	Remove playground.	AMP indicates that playground replacement is required in 2021/22. New playground to east will cover a variety of ages.	High Phase 1
6	Trees (new)	Plant additional trees around playground.	Additional shade required around the playground area.	High Phase 1
NA	Trees (new)	Explore potential for including suitable large-growing character species (iconic trees) in key focal areas to provide landscape variety and intergenerational landscapes (eg Queensland Bottle Tree, Italian Stone Pine or Cork Oak).	Intergenerational landscapes.	High Phase 1
7	Barbecue (south of playground)	Replace with new DDA compliant barbecue, shift south-west of rotunda.	Due for replacement according to AMP.	High Phase 2

# Master Plan

Map #	Element	Action	Justification	Priority /Phase
8	Bin (eastern edge of park)	Install new bin with dog bag dispenser affixed.	47% Park users requested additional bins.* Walkers leaving Park from eastern side do not have anywhere to put rubbish. Dog bag dispenser currently in place.	High Phase 2
NA	Bin (east of toilet)	Remove bin.	Surplus to needs, as additional bin located nearby at bus shelter.	High Phase 2
9	Connection to Romalo Reserve	Improve link by installing new signage, formalising trail surface and making access point more visible.	Recommended in Open Space Strategy, to improve links between open spaces. The access area between Penfold Park and Romalo Avenue is not obvious to the casual park user.	High Phase 2
10	Courts	Allow multipurpose use of courts, including line marking for alternate sports.	Increasing demand for other sports on courts in City of Burnside.	High Phase 2
10	Courts	Investigate treatment options including fungicide.	Fungal growths on surface require removal and ad hoc patching.	High Phase 2
11	Drink fountain (east of courts)	Install new drinking fountain with dog bowl.	62% Park users requested additional drinking fountains.*	High Phase 2
12	Drink fountain (south of toilet)	Replace with new drinking fountain located in a more prominent location near toilets.	Current drinking fountain is due for replacement.	High Phase 2
13	Fitness stations	Install fitness stations near pathway.	38% Park users requested fitness equipment.*	High Phase 2
14	Irrigation	Install new irrigation system, especially on lawn area near playground.	Current system installed in 1993, no longer effective.	High Phase 2
14	Lawn	Improve soil to better support turf. Top dress and reseed lawn when new irrigation is installed.	In poor condition – patchy with many weeds.	High Phase 2

Map #	Element	Action	Justification	Priority /Phase
	Lighting	Replace existing lighting along internal path. Install additional lighting along new paved path.	Condition of lighting did not rate well by Park users.* Improved lighting would further increase safety for Park users at night.	High Phase 2
15	Seating	Install new seats around playground when it is replaced.	73% Park users requested additional seating.* Seating is lacking near playground.	High Phase 2
16	Trees (new)	Plant new indigenous trees on sloping lawns to provide shade and wildlife resources.	Increase of shade and wildlife resources.	High Phase 2
NA	Water Sensitive Urban Design (WSUD)	Investigate (Phase 2) and implement (Phase 3) WSUD measures to improve downstream stormwater quality.	The Stormwater Infrastructure Capacity Study 2017 noted that Penfold Park has a high potential for WSUD measures, as there is good available area for a sedimentation/bio-filtration basin or swale and the park serves a reasonable urban catchment.	High Phase 2
NA	Art trail	Investigate opportunities for future community art.	Public art has the ability to bring people together, start conversations and activate spaces.	Medium Phase 3
17	Picnic setting (south of playground)	Move to south-west of rotunda, next to new barbecue.	Currently no cohesive feel to the placement of barbecue and picnic setting.	Medium Phase 3
18	Barbecue (south of courts), shelter and picnic setting	Install new DDA compliant barbecue and picnic setting under new shelter.	33% Park users requested additional BBQ facilities, 55% requested additional shelter and 57% requested additional picnic settings.*	Medium Phase 3
NA	Car park gate	Remove car park gate.	Gate was originally installed to prevent night-time anti-social behaviour at old toilet block. Issue now resolved. Gate in poor condition.	Medium Phase 3

# Master Plan

Map #	Element	Action	Justification	Priority /Phase
NA	Entry path	Remove section of redundant concrete edging (previous path location), plant area with lawn.	Remnants of old concrete edging remains at Romalo Avenue entrance. Scouring also present in this area.	Medium Phase 3
19	Plantings	Investigate low to mid-level native plantings over sloped areas and around small rotunda.	Areas of bare earth on eastern slopes of Park.	Medium Phase 3
NA	Wildlife habitat and connectivity	Explore opportunities for increasing diversity of local native plant species in existing plantings, including mid-canopy and understorey species.	Listed in Environmental Sustainability Strategy 2019-2023. 2021 project: Habitat planning for corridors and threatened species in the City of Burnside.	Medium Phase 3
20	Drainage basin	Seek engineering advice to upgrade drainage area to remove stagnant pools of water.	Water is pooling in sections, caused by water erosion from water flowing over structures in creek.	Medium Phase 4
21	Signage	Install new entry signage at The Parade and Romalo Avenue entrances. Incorporate Park rules on entry signs where possible, including by-law 3 which prohibits driving on reserves. Remove signs that are no longer required.	Entry sign on The Parade entrance is dated. No entry sign exists on Romalo Ave entrance. Other signs have been installed in a haphazard manner as required, and some are no longer required while others can be consolidated on new entry signs.	Medium Phase 4
NA	Connection to nearby hills face trails and reserves	Develop new trailhead to direct trail users to reserves and walking trails in nearby hills face conservation reserves.	Recommended in Draft Conservation Trails Review 2020.	Low Phase 5
22	Educational nature trail	Install educational signage along path through tree area (eg information about flora and fauna).	66% Park users requested nature play.* Unstructured play in nature is readily available, however, an educational nature trail will further encourage this.	Low Phase 5

<b>Map #</b>	<b>Element</b>	<b>Action</b>	<b>Justification</b>	<b>Priority /Phase</b>
23	Rotunda (small and large)	Add bench seating to internal perimeter of large and small rotundas.	73% Park users requested additional seating.* Rotundas only have one bench seat each.	Low Phase 5
24	Basketball hoop and key	Maintain in good condition.	Newly installed in 2021.	Ongoing
25	Car park	Maintain in good condition.	Currently in good condition.	Ongoing
NA	Paths (paved)	Maintain.	Maintain in good condition.	Ongoing
26	Toilet	Maintain in good condition.	Newly installed in 2019.	Ongoing
27	Trees - pear grove and native trees (existing)	Maintain.	Trees were the most popular element of the park.*	Ongoing
NA	Woody weed removal	Remove pest plants such as Olives, Italian Buckthorn and Desert Ash that have self-seeded into mulched beds and drainage line.	Legislative obligation to control Declared Pest Plants (Landscape SA Act 2019).	Ongoing



[www.burnside.sa.gov.au](http://www.burnside.sa.gov.au)